



### F&D WARRANTY CARD

#### END-USER'S COPY

#### WARRANTY REGISTRATION CERTIFICATE

\*\*\*\*\*

Mr./Mrs/Ms First Name: \_\_\_\_\_

Last Name: \_\_\_\_\_

Address: \_\_\_\_\_

Contact No.: \_\_\_\_\_

Product Name: \_\_\_\_\_

Model No.: \_\_\_\_\_

Serial No.: \_\_\_\_\_

Date Purchased: \_\_\_\_\_

Invoice No.: \_\_\_\_\_

Retail Outlet Where Purchased: \_\_\_\_\_

(Please print the name & address)

**SECTION 1**

#### WARRANTY TERMS & CONDITIONS

\*\*\*\*\*

The warranty will be effective only if the warranty card is completed and returned to the company within 14 days from the date of purchase. We guarantee the provision of free services of **F&D** product within the warranty period from its date of purchase from our Authorised Dealer. The period and conditions of our warranty service are as follow:

1. The warranty covers services by our **F&D** Authorised Dealer. This warranty card together with the receipt must be presented when servicing is required. This warranty card is irreplaceable in the event of loss.

2. Repair services will be provided for defects arising from normal usage for the following period, commencing from the date of purchase from our **F&D** Authorised Dealer. (Parts would be replaced when necessary)

A. Parts:..... 1 year

B. Technical service free..... 1 year

3. Under the following circumstances, service and parts will be chargeable even within the warranty period:

A. Failure to present the warranty card and receipt when servicing is required. Full particulars not clearly shown or alterations made against the actual information. For e.g.: Alteration of the date of purchase, serial numbers-altered or removed.

B. This unit being tampered with, altered in any way by any unauthorised technicians or which has been subjected to misuse, negligence or accident. This guarantee does not cover damage occurring in transit by or from the customer.

C. The defect is caused by the attack of household pests, fire, lighting, natural disasters, pollution, abnormal voltage or the usage of generator.

Shenzhen Fenda Technology Co., Ltd.  
 Add : Fenda Hi-Tech Park, Zhoushi Road, Shiyao, Baoan, Shenzhen, China  
 P.C. : 518108 Http://www.fenda.com

### F&D WARRANTY CARD

#### DISTRIBUTOR'S COPY

#### WARRANTY REGISTRATION CERTIFICATE

\*\*\*\*\*

Mr./Mrs/Ms First Name: \_\_\_\_\_

Last Name: \_\_\_\_\_

Address: \_\_\_\_\_

Contact No.: \_\_\_\_\_

Product Name: \_\_\_\_\_

Model No.: \_\_\_\_\_

Serial No.: \_\_\_\_\_

Date Purchased: \_\_\_\_\_

Invoice No.: \_\_\_\_\_

Retail Outlet Where Purchased: \_\_\_\_\_

(Please print the name & address)

**SECTION 2**

#### WARRANTY TERMS & CONDITIONS

\*\*\*\*\*

The warranty will be effective only if the warranty card is completed and returned to the company within 14 days from the date of purchase. We guarantee the provision of free services of **F&D** product within the warranty period from its date of purchase from our Authorised Dealer. The period and conditions of our warranty service are as follow:

1. The warranty covers services by our **F&D** Authorised Dealer. This warranty card together with the receipt must be presented when servicing is required. This warranty card is irreplaceable in the event of loss.

2. Repair services will be provided for defects arising from normal usage for the following period, commencing from the date of purchase from our **F&D** Authorised Dealer. (Parts would be replaced when necessary)

A. Parts:..... 1 year

B. Technical service free..... 1 year

3. Under the following circumstances, service and parts will be chargeable even within the warranty period:

A. Failure to present the warranty card and receipt when servicing is required. Full particulars not clearly shown or alterations made against the actual information. For e.g.: Alteration of the date of purchase, serial numbers-altered or removed.

B. This unit being tampered with, altered in any way by any unauthorised technicians or which has been subjected to misuse, negligence or accident. This guarantee does not cover damage occurring in transit by or from the customer.

C. The defect is caused by the attack of household pests, fire, lighting, natural disasters, pollution, abnormal voltage or the usage of generator.

Shenzhen Fenda Technology Co., Ltd.  
 Add : Fenda Hi-Tech Park, Zhoushi Road, Shiyao, Baoan, Shenzhen, China  
 P.C. : 518108 Http://www.fenda.com



### F&D

#### CAUTION

- Do not place the system in the high-temp and humid environment, prevent it from raining or rough handling and strong shock.
- In order to avoid electric shock and other accidents, do not open the right side panel cover for repair without any professional guidance.
- In case fragments or other liquids are accidentally sprinkled inside the cabinet, please switch off the power immediately. In case of repair pls. Come to the professional maintenance for help.
- Switch off the power and take off the plug from the power jack when the system is not on work.
- Keep it safe from water drops or splashing water, and no liquid container allowed to be put on its top side.
- Keep the cabinet vent far from the wall by 20mm at least and the air vent should not be blocked.
- Do not keep it close to the fire.

#### FEATURES

- 30W subwoofer, powerful bass
- Smart LED display, colorful RGB lighting effect
- Supports Bluetooth, AUX, USB, COXIAL audio input at the same time

#### SYSTEM COMPOSITION

Subwoofer unit	1pc	Operation manual	1pc
Satellite speakers	2pcs	3.5mm to RCA stereo cable	1pc
Remote control	1pc	AAA Battery	2pcs

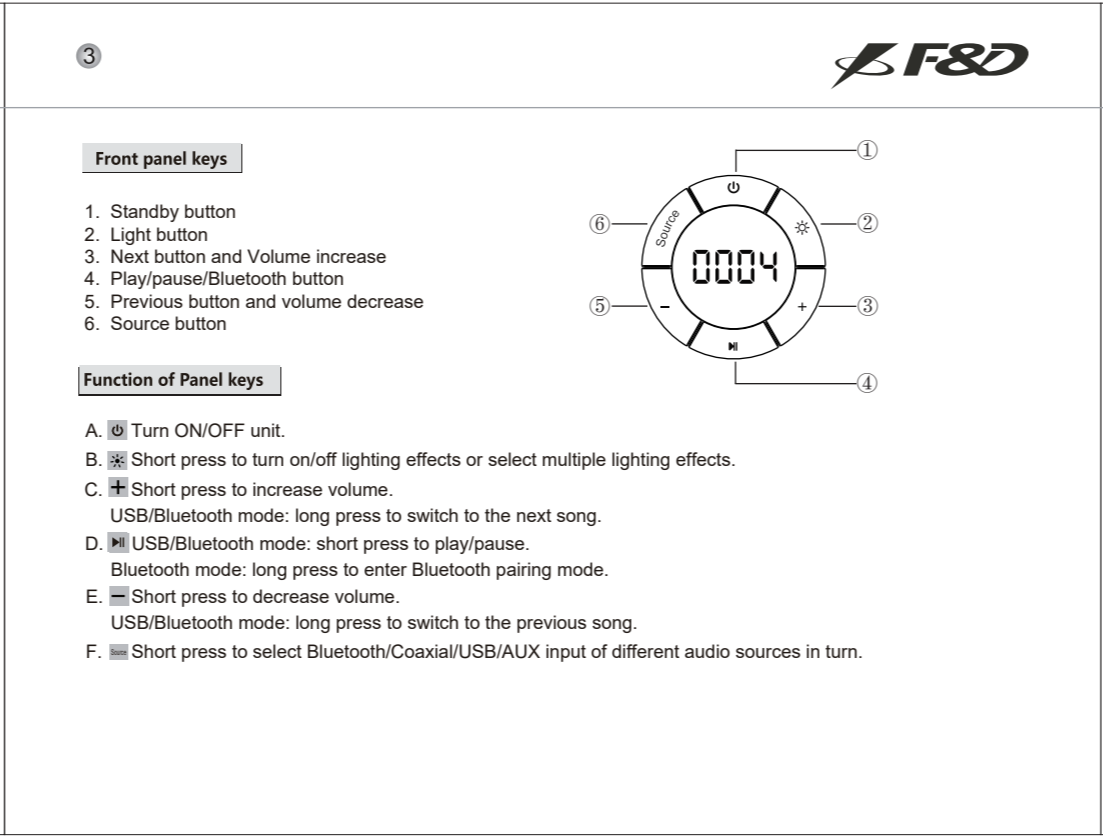
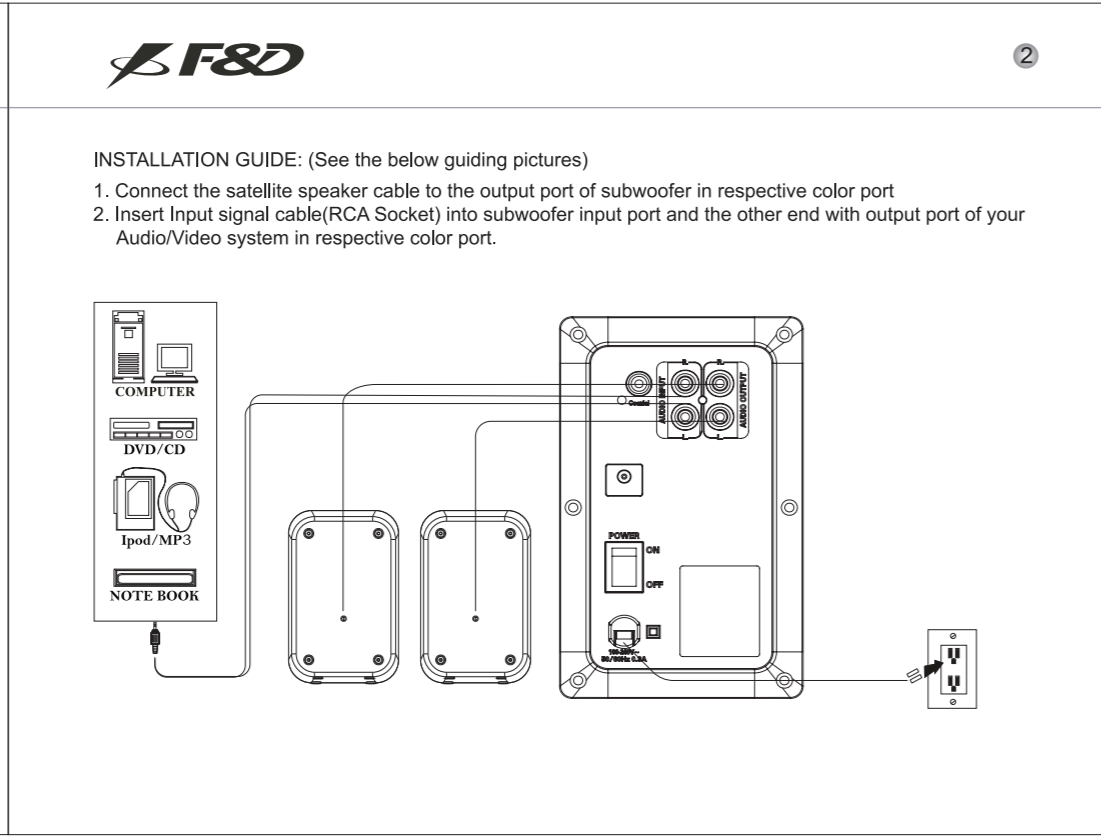

### F&D

#### Remote control

A. Turn ON/OFF unit.

B. Press it to mute or unmute the sound.

C. Bass-/Bass+ Short press to decrease/increase bass volume.

D. TRE-/TRE+ Short press to decrease/increase treble volume.

E. Previous song

F. Next song

G. USB mode: short press to select the previous song, long press to select the previous file.

H. Bluetooth mode: short press to select the previous song.

I. USB mode: short press to select the next song, long press to select the next file.

J. Bluetooth mode: short press to select the next song.

K. USB/Bluetooth mode: short press to play/pause music.

L. Short press to select Bluetooth/Coaxial/USB/AUX input of different audio.

M. Short press to switch to Bluetooth mode. Long press to enter the Bluetooth pairing mode, search for the Bluetooth name "Fenda F590X".

N. 0-number: USB mode: Press the number keys 0-9, The display will show the corresponding song number, and automatically choose to the corresponding song by default after 3 seconds.

**Notice:** Compatible with Smartphones and tablets supporting Bluetooth (A2DP) protocol

### F&D

#### Coaxial Mode

- Short press to switch audio source to coaxial mode. Connect the speaker with audio source through coaxial cable.
- please make sure to set "PCM mode" as digital output on your devices, such as Blue-ray DVD, TV and Video player, etc. Below as example.
- Adjust volume while playing music.

#### Bluetooth Mode

- Bluetooth connection operation instructions: Short press to switch to Bluetooth mode, search for the Bluetooth name "Fenda F590X"; After the connection is successful can be play music.
- Connect two devices at the same time to play music:
  - Connect one Bluetooth device(According to step 1).
  - Long press the Bluetooth speaker pairing button to disconnect and enter the pairing state, and the other Bluetooth device can be search and connect speakers. At this time, the two devices connected to "Fenda F590X" at the same time.
- After the connection is successful, Users can choose any one to play music according to their needs.

### F&D

#### Specifications

Output power : 60W(30W+15W\*2)

**speaker unit**

Full Range speaker : 3"

Subwoofer : 5.25"

**Frequency response**

Subwoofer : 35Hz-140Hz

Satellite : 200Hz-20KHz

S/N Ratio : ≥70dB

Separation : ≥40dB

Net weight : 4.2Kg

Power supply : 100-240V~50/60Hz 0.3A

**Unit size**

Subwoofer : W205XD268XH305MM

Satellite : W120XD120XH189MM

#### Troubleshooting

Problem	Possible Cause	Solution
F&D system does not turn on	Power cable not connected to the power outlet and/or F&D System	Check connection
Sound reproduction too soft	Volume of F&D System set too low	Increase the volume using the "Volume" button, increase the volume of the source device
F&D System does not respond to remote control.	The battery is empty	Replace battery, observe correct polarity at insertion
No sound reproduction	Source device not producing any signal.	Digital output on the source device not activated
	Cable not correctly connected/faulty	Check the connection of the source device to the F&D System and change the cable if necessary.
	Distance is far from device in Bluetooth mode	Put your Bluetooth device close to the speaker
	Bluetooth device not connected successfully	Please restart the speaker and try again
Speaker can not connect to desktop or notebook through Bluetooth	No right Bluetooth driver software installed in desktop or notebook	Find desktop or notebook service to get right Bluetooth driver software and install